

Sea-Doo Supercharger Shim Kit

RS17080-SSK

Applications: 2008+ Sea-Doo 1503 & 1630 Superchargers

This kit is intended to enable more accurate supercharger slip moment calibration for modified superchargers in good running order. If the slip moment is out of specification prior to upgrading your supercharger a new OEM Supercharger Shaft Assembly should be installed, or the supercharger replaced, prior to upgrading your supercharger. See 'Supercharger Service Reference Chart'.

Supercharger Service Reference Chart

Model (HP)	Rebuildable	Replace
215	✓	✗
230	✗	✓
255	✓	✗
260 (2012~16)	✓	✗
260 (2017)	✗	✓
300 (2016~17)	✓	✗
300 (2018 & newer)	✗	✓

INSTALLATION INSTRUCTIONS

If it is necessary to add shims to achieve proper slip moment, install between L-ring (2) and Spring Washers (4) **ONLY**.

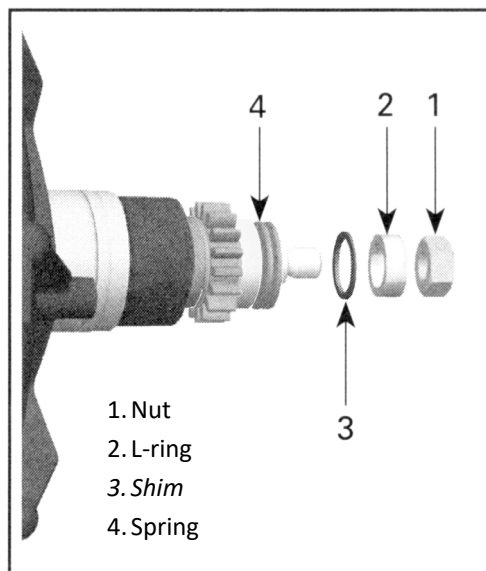
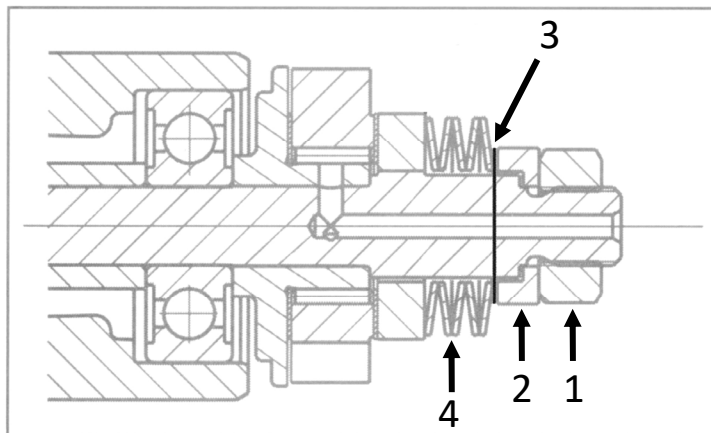

NOTE: This kit is not intended to replace rebuilding a supercharger that is out of spec.

Technical Support

For answers to questions regarding installation or trouble shooting RIVA Performance Products contact:
RIVA Technical Support directly at (954) 247-0705 or by e-mail at tech_support@rivaracing.com.

Limited Warranty

Due to the nature of performance applications, this product is sold without any express warranty or any implied warranty of merchantability or fitness or a particular purpose. RIVA Racing shall not, under any circumstances, be liable for any special, incidental or consequential damages, including, person, party or property, but not limited to, damage, or loss of property or equipment, loss of profits or revenue, cost of purchased or replacement goods, or claims of customers of the purchase, which may arise and/or result from sale, installation or use of these parts. Installation of this part will void the motor manufacturer's warranty coverage.