



**RIVA RACING**  
PERFORMANCE PRODUCTS & ACCESSORIES

**Pump Seal Kit**  
**PART# - RY25060**

**APPLICATION(S):** Yamaha VXR/S Models (RIVA SS Intake Grate Only – Part# RY22060)

**\*\*\* DISCONNECT BATTERY BEFORE PERFORMING INSTALLATION \*\*\***

**- INSTALLATION INSTRUCTIONS -**

Remove lanyard.

Disconnect battery cables. **NOTE: Negative (black) first. Positive (red) second.**

Remove bolts (4) securing intake grate to hull. **NOTE:** It may be necessary to apply heat to bolts to make removal easier. Do so in small amounts.

Install the two large, flat pieces of Pump Seal Kit into transom plate.



Insert the two narrow pieces of Pump Seal Kit into rear opening of RIVA SS Intake Grate.

**NOTE: Pieces are tapered and radiused to match intake grate.**

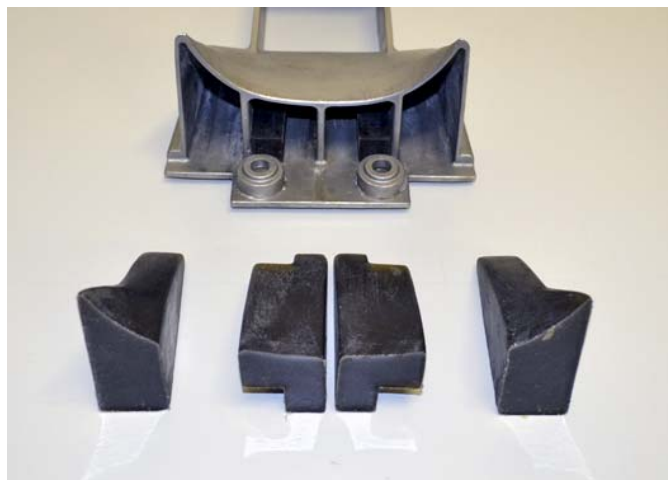

Insert remaining pieces of Pump Seal Kit into rear opening of RIVA SS Intake Grate.

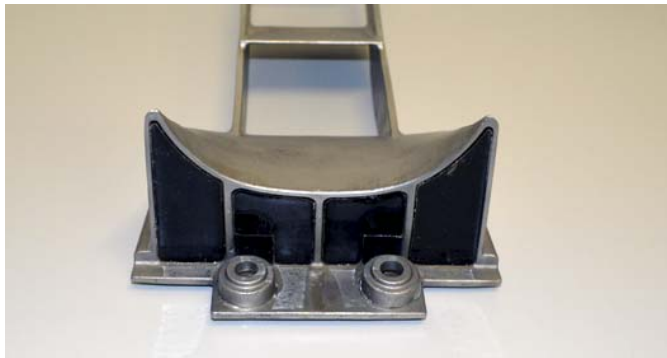

Test fit intake grate to ensure it seats properly in hull. Variances in materials (hull, transom plate, pump seal kit) may require the Pump Seal Kit be relieved to allow intake grate to be installed properly.

Remove intake grate. Seal transom plate to pump inlet tunnel/hull using 'below waterline' silicone sealant leaving a smooth transition from hull to transom plate.



Apply a generous amount of 'below waterline' silicone sealant to all exposed surfaces of pump seal kit inserts in intake grate.



Apply generous amount to edges/sides of intake grate and front of intake grate.



Install intake grate and secure with stock bolts. **NOTE: Apply blue Loc-tite to bolts. Torque to 29 lbf•in / 40 N•m.**

Remove excess silicone leaving a smooth transition from hull to intake grate.

Allow silicone to dry for a minimum of 24 hours.

Reconnect battery. **NOTE: Positive (red) first. Negative (black) second.**

***Remember, the water belongs to everyone.  
Please ride responsibly and respect the environment!***

#### **Technical Support**

For answers to questions regarding installation or trouble shooting RIVA Performance Products contact: RIVA Technical Support directly at (954) 247-0705 or by e-mail at [tech\\_support@rivamotorsports.com](mailto:tech_support@rivamotorsports.com)