



RIVA RACING
PERFORMANCE PRODUCTS & ACCESSORIES

Pro-Series Sponsons

PART# - RS26110

APPLICATION(S): 2012 Sea•Doo RXP-X 260 & RXT-X 260 aS models

We strongly recommend the use of a service manual to familiarize yourself with the various components and procedures involved with this installation. These instructions have been written in step-by-step format and refer to illustrations. Read through instructions entirely before performing installation. Please follow these step-by-step instructions and illustrations carefully.

Required Specialty Tools

T45 Torx Bit

Part#

N/A

- INSTALLATION INSTRUCTIONS -

Remove stock sponson blades (5 Torx bolts each side).
DO NOT REMOVE BACKING PLATES.



Discard stock sponson blades and hardware.

Clean threaded inserts in stock backing plates using compressed air.

Install supplied Pro-Series Sponsons using supplied M8 bolts & wave washers. **NOTE: Apply blue Loctite to threads. Torque bolts to 13 ft•lb / 159 in•lb / 18 N•m.**



SPONSON TUNING RECOMMENDATIONS

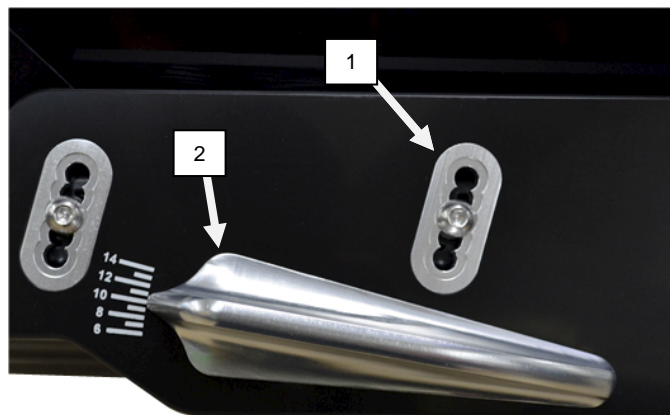

1) Sponson Blades: Billet inserts provide 5 vertical adjustment positions. All the way up is the least aggressive. All the way down is the most aggressive.

2) Stabilizer Wings: The billet stabilizer wings provide 5 degrees of adjustment. They come preset in the neutral position (same as stock). All the way up is the most aggressive. All the way down is the least aggressive. To adjust loosen the three M5 allen bolts on the rear of the sponson blade.

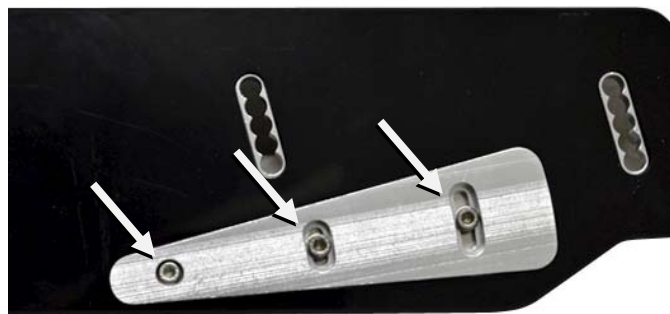

After finding your favorite position remove bolts one at a time, apply blue Loctite to threads and replace. **Torque bolts to 3.5 ft•lb / 44 in•lb / 5 N•m.**

Check bilge for tools, rags, etc. Run craft on a flush kit to check for proper operation.

Remember, the water belongs to everyone.

Please ride responsibly and respect the environment!

Technical Support

For answers to questions regarding installation or trouble shooting RIVA Performance Products contact:

RIVA Technical Support directly at (954) 247-0705 or by e-mail at tech_support@rivamotorsports.com.

Limited Warranty

RIVA Pro-Series Sponsons carry a 30-day limited warranty to the original purchaser. They are warranted to be free of defects in materials and workmanship under normal use and service. Customer modified components will be void of warranty. This warranty is limited to defects in the primary components only. Finish and/or wear marks in or on primary components are not covered under this warranty.

RIVA Racing's liability is expressly limited to the repair or replacement of the components contained within or associated with this kit. RIVA Racing agrees to repair or at RIVA's option, replace any defective unit without charge, if product is returned to RIVA Racing freight prepaid within the warranty period. Any equipment returned which, in RIVA's opinion, has been subjected to misuse, abuse, overheating or accident shall not be covered by this warranty.

RIVA Racing shall have no liability for special, incidental or consequential damages or injury to persons or property from any cause arising from the sale, installation or use of this product.

No other warranty, express or implied, including, but not limited to the implied warranties of merchantability and fitness for a particular purpose, applies. Various states do not allow for the limitation of incidental or consequential damages and therefore the above exclusion or limitation may not apply to you.

Warranty does not include the expenses related to freight or transportation of parts or compensation for any inconvenience or loss of use while being repaired. A copy of the original invoice and a Return Authorization Number (RA#) must accompany all warranty claims.

Warranted replacement parts will be returned freight collect.