



## **Heavy-duty Supercharger Spring Washers**

***PART# - RS17050-SWP-948***

We strongly recommend the use of a service manual to familiarize yourself with the various components and procedures involved with this installation. Please note that some of the original clamps, hoses and hardware removed in the disassembly process will be used in the installation process. These instructions have been written in step-by-step format and refer to illustrations. Read through instructions entirely before performing installation. Please follow these step-by-step instructions and illustrations carefully.

**APPLICATION(S):** All 260/255/215 4-TEC engines

### **\*\*\* ALLOW ENGINE TO COOL COMPLETELY BEFORE PERFORMING INSTALLATION \*\*\***

#### **Required tools**

Torx Screw Adapter  
Impeller Shaft Holder

#### **Recommended tools**

Service Manual

#### **Part#**

529 035 938  
RS1750-HDW-949

#### **Part#**

*Please call*

### **- INSTALLATION INSTRUCTIONS -**

Remove D.E.S.S. lanyard.

#### **Fixed Deck Models:**

Remove seat bridge (RXT-X, RXT & GTX models) or engine compartment cowling (255 RXP-X & 215 RXP models).

#### **Suspension Models:**

You are required to remove the moving deck to perform this installation. Please refer to the OEM Service Manual for this process.

Remove inlet and outlet hoses attached to supercharger unit.

Disconnect exhaust pipe from exhaust manifold.

Disconnect muffler (water box) restraining strap and slide muffler rearward.

**NOTE:** You will need a special Torx adapter to remove and replace the supercharger. This can be purchased through our parts department, at any SeaDoo Dealer or reputable tool company.

Remove Torx bolts (2 lower/front & 1 upper/rear) securing supercharger to engine.

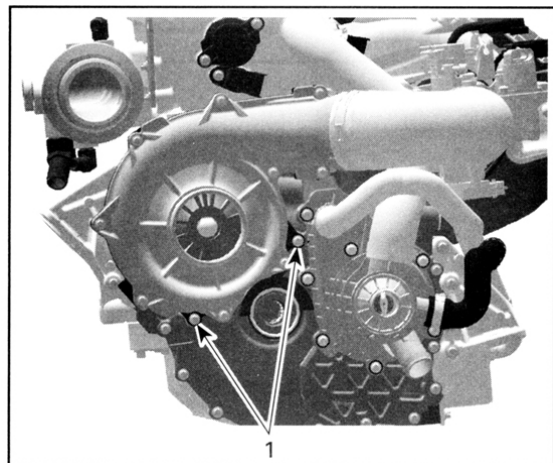
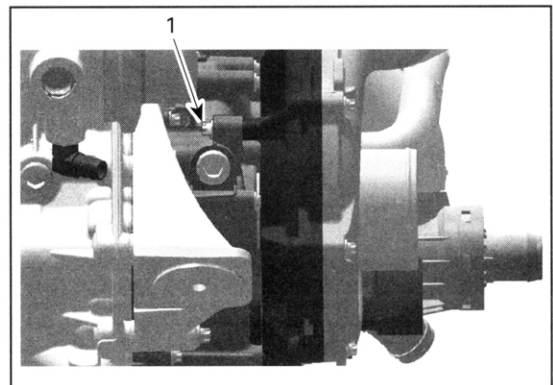

Remove supercharger unit from engine.

**NOTE: It is extremely important that the area utilized to work on the supercharger unit is very clean. Any foreign debris introduced into the supercharger unit will cause damage.**

Secure impeller shaft at rear of supercharger unit using SeaDoo shaft holding tool.

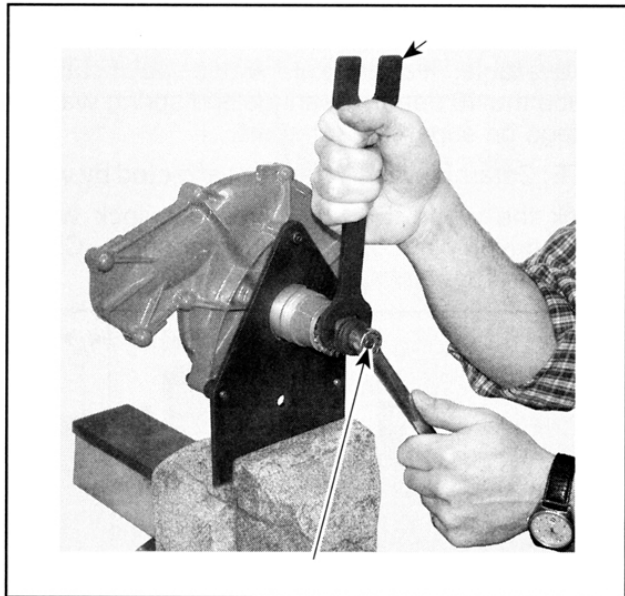

Remove nut, angular ring and spring washer pack.  
Discard spring washers.

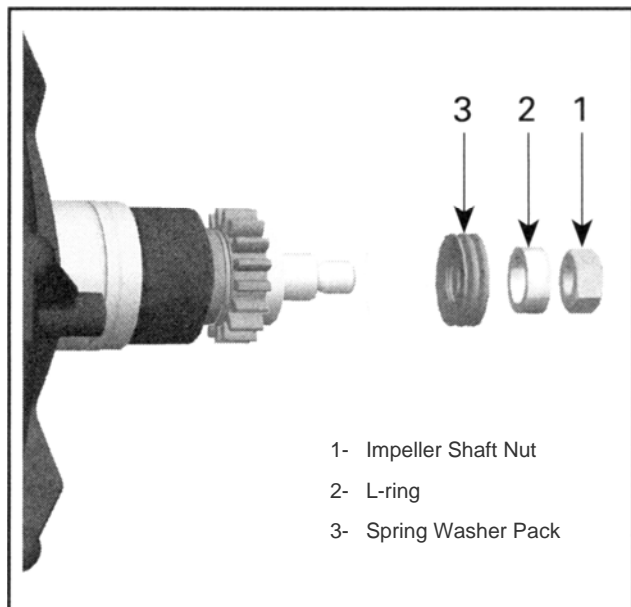

Carefully clean exposed portion of supercharger impeller shaft with a non-residual cleaner.

Clean angular ring and impeller shaft nut with a non-residual cleaner.

Clean supplied Heavy-duty Spring Washers with a non-residual cleaner.

Coat components to be installed with BRP 4-stroke XPS oil. **NOTE: Use only BRP 4-stroke XPS oil in your supercharged engine.**

Install spring washers in the following order.

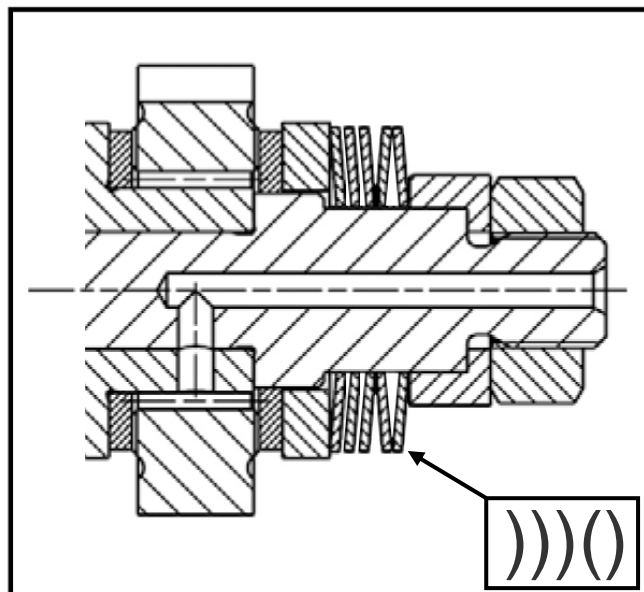

**NOTE: Order is important. Install as directed in illustration above.**

Install angular ring and impeller shaft nut. **NOTE: Apply RED Loctite to threads inside impeller shaft nut. Torque nut to 22 ft•lbs / 30 N•m.**

Spin supercharger impeller to ensure smooth operation.

Inspect o-rings on engine side of supercharger housing. If either is damaged replace both.

Coat unpainted area on engine side of supercharger unit with anti-seize.

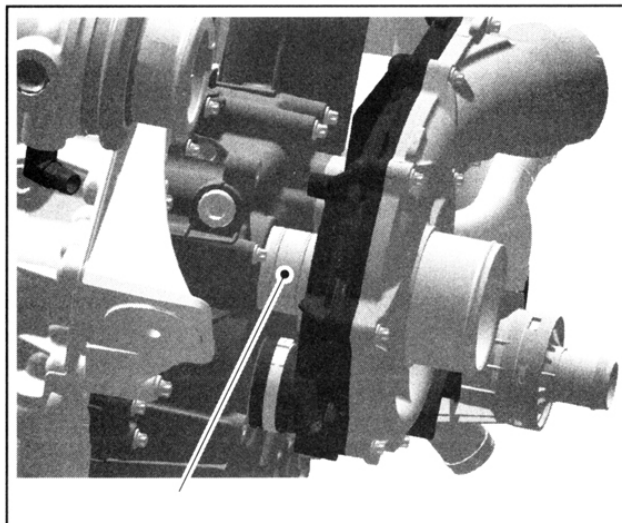

Install supercharger unit onto engine. **NOTE:** It may be necessary to rotate supercharger impeller to allow supercharger gear to mesh with flywheel gear.

Secure supercharger unit to engine. **NOTE: Use BLUE Loctite. Torque to 89 lbf•in / 10 N•m.**

Reconnect exhaust pipe to exhaust manifold. **NOTE: Do not over tighten T-bolt nut on clamp.**

Secure muffler (water box).

Replace supercharger inlet and outlet hoses and exhaust outlet hose.

#### **Fixed Deck Models:**

Replace seat bridge (RXT-X, RXT & GTX models) or engine compartment cowling (255 RXP-X & 215 RXP models).

#### **Suspension Models:**

Replace moving deck. Please refer to the OEM Service Manual for this process.

Check bilge for tools, rags, etc. Run craft on a flush kit to check for proper operation.

***Remember, the water belongs to everyone.  
Please ride responsibly and respect the environment!***

#### **Technical Support**

For answers to questions regarding installation or trouble shooting RIVA Performance Products contact: RIVA Technical Support directly at (954) 247-0705 or by e-mail at [tech\\_support@rivamotorsports.com](mailto:tech_support@rivamotorsports.com).

#### **Limited Warranty**

RIVA Heavy-duty Spring Washer Kits carry a 90-day limited warranty to the original purchaser. They are warranted to be free of defects in materials and workmanship under normal use and service. Customer modified components will be void of warranty. This warranty is limited to defects in the primary components only. Finish and/or wear marks in or on primary components are not covered under this warranty.

RIVA Racing's liability is expressly limited to the repair or replacement of the components contained within or associated with this kit. RIVA Racing agrees to repair or at RIVA's option, replace any defective unit without charge, if product is returned to RIVA Racing freight prepaid within the warranty period. Any equipment returned which, in RIVA's opinion, has been subjected to misuse, abuse, overheating or accident shall not be covered by this warranty.

RIVA Racing shall have no liability for special, incidental or consequential damages or injury to persons or property from any cause arising from the sale, installation or use of this product.

No other warranty, express or implied, including, but not limited to the implied warranties of merchantability and fitness for a particular purpose, applies. Various states do not allow for the limitation of incidental or consequential damages and therefore the above exclusion or limitation may not apply to you.

Warranty does not include the expenses related to freight or transportation of parts or compensation for any inconvenience or loss of use while being repaired. A copy of the original invoice and a Return Authorization Number (RA#) must accompany all warranty claims.

Warranted replacement parts will be returned freight collect.