

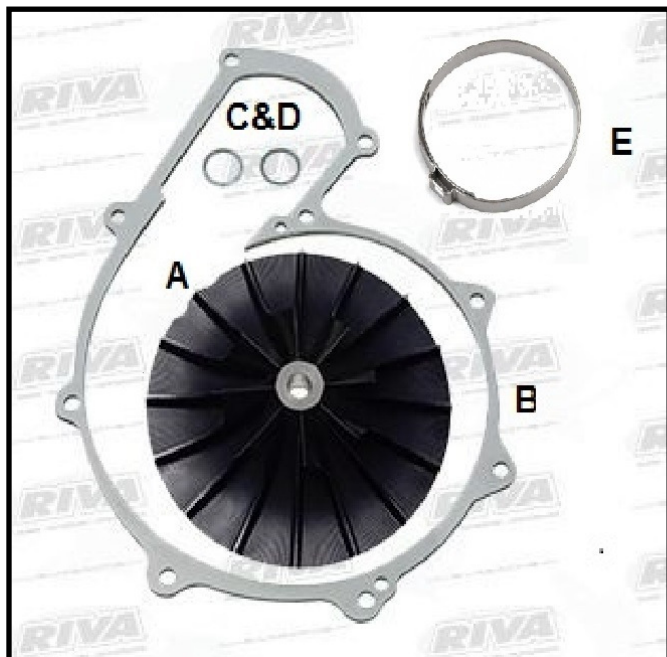

RIVA RACING
PERFORMANCE PRODUCTS & ACCESSORIES

Supercharger Impeller and Spacer Kit

PART# - RS1750-001C



Note: Installation of this kit into Sea-Doo 215 models requires that the OEM fuel injectors be replaced with 42lb. fuel injectors such as RIVA part number 0280155968.

Failure to do so will result in serious engine damage.

Applications: Sea-Doo 215 Engines

Approximate Installation Time: 1hr.

Recommended Specialty Tools:

	<u>Part #</u>
Torx Screw Adaptor	529 035 938
Impeller Shaft Holder	RS1750-ISH-949
Oetiker Plier	C-48550347
Torque Wrench	N/A
Service Mounting Plate	529 035 947

Required Materials:

	<u>Part #</u>
Blue Loc-Tite	N/A
Loc-Tite 5910 Sealant	N/A

We strongly recommend the use of a service manual to familiarize yourself with the various components and procedures involved with this installation. Please note that some of the original hardware removed in the disassembly process will be used in the installation process. These instructions have been written in step-by-step format and refer to illustrations. Read through instructions entirely before performing installation. Please follow these step-by-step instructions and illustrations carefully.

***** ALLOW ENGINE TO COOL COMPLETELY BEFORE PERFORMING INSTALLATION *****

***** NO SMOKING *** NO SMOKING *** NO SMOKING *****



RIVA RACING
PERFORMANCE PRODUCTS & ACCESSORIES

RS1750-001C Impeller and Spacer Kit

COMPONENT LIST

		QUANTITY	PART NUMBER	DESCRIPTION
A	<input type="checkbox"/>	1		Impeller
B	<input type="checkbox"/>	1		Spacer Plate
C	<input type="checkbox"/>	1	98089A224	Shim 0.10mm
D	<input type="checkbox"/>	1	98089A263	Shim 0.20mm
E	<input type="checkbox"/>	1	16700077	Oetiker Clamp

Packed with pride by: _____

Your kit was inspected and verified before being carefully packaged by our staff. Please check package contents before beginning assembly. If you have a question about missing or damaged items please contact RIVA Technical Support directly at (954) 247-0705 or by e-mail at tech_support@rivamotorsports.com

- INSTALLATION INSTRUCTIONS -

Disconnect battery cables. **NOTE: Negative (black) first. Positive (red) second.**

Remove inlet and outlet hoses attached to supercharger unit.

Remove the two M6 x 35mm Torx bolts(1) that secure supercharger unit to engine. (Figure 1)

Figure 1

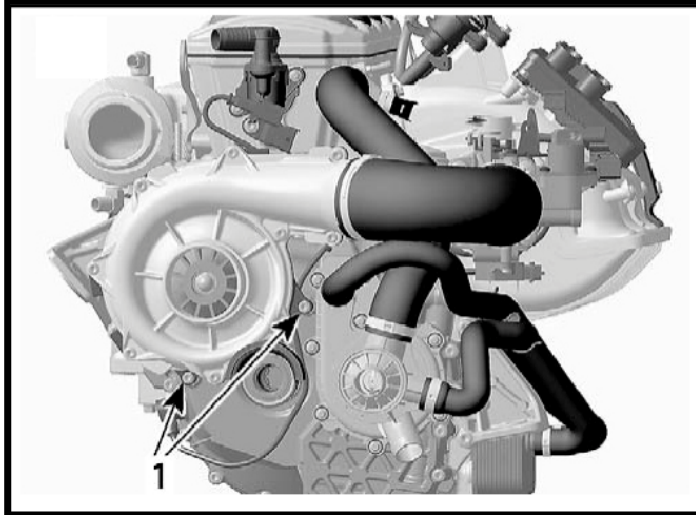

Remove the one M6 x 35mm Torx bolt (1) that secures rear of supercharger unit to engine. **NOTE:** You will need a special Torx adapter to remove and replace the upper/rear Torx bolt. This can be purchased through our parts department, a Sea•Doo Dealer, or a reputable tool company. (Figure 2)

Figure 2

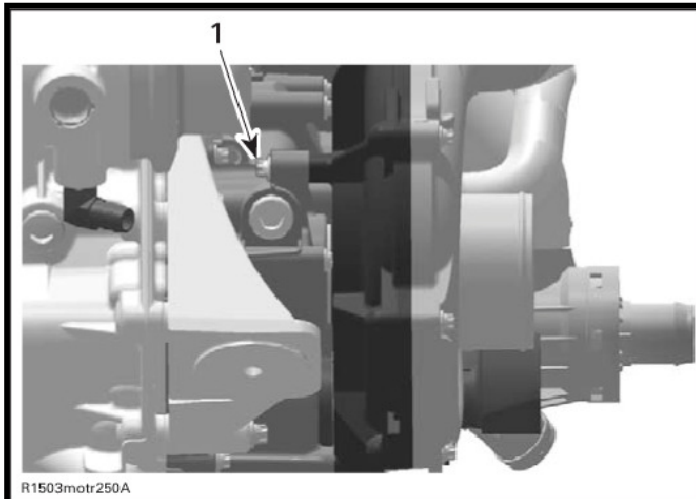

Remove supercharger unit from engine. **NOTE:** It is extremely important that the area utilized to work on the supercharger unit is very clean. Any foreign debris introduced into the supercharger unit will cause damage. It is equally important that care is taken when performing the following steps so as not to damage the impeller or working parts of the supercharger unit. Even a small mark on the impeller would ruin the dynamic balance causing severe damage.

NOTE: Before proceeding we recommend you verify slip clutch is operating properly. This should be done before disassembling supercharger unit. Please refer to your Sea-Doo service manual for procedure. If the torque is not within OE specification, repair the supercharger clutch.

The slip moment setting for the RIVA 001C should be 14-15 foot lbs. It may be necessary to use one or both of the shims supplied with this kit to achieve this value.

If it is necessary to add shims to achieve proper slip moment, install shim(s) between the L-ring and the spring washers. (between #2 & #3)(Figure 3)

Figure 3

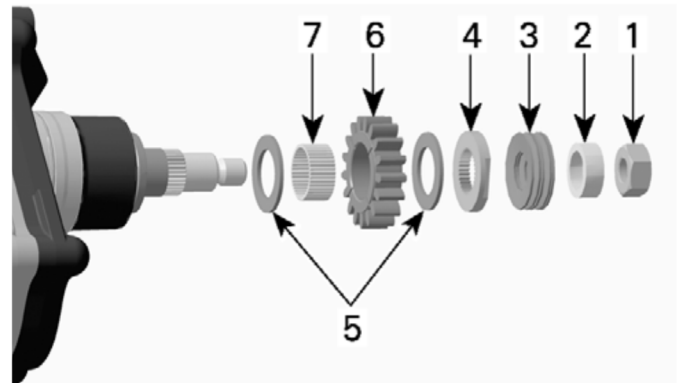

1. Nut 4. Lock Washers
2. L-ring 5. Friction shims (clutch washers)
3. Spring washers (5x) 6. Drive gear
7. Needle Pins

Secure supercharger unit to service mounting plate and place in a securely mounted bench vise.

Remove the nine M6 x 35mm Torx screws (1) securing impeller cover (2) to supercharger (3).Figure 4

Figure 4

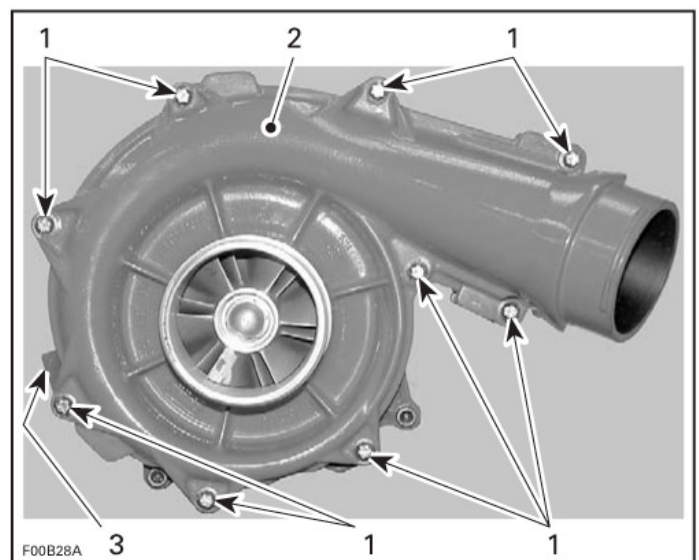

- INSTALLATION INSTRUCTIONS -

Remove impeller cover. **NOTE:** It may be necessary to tap the cover in order to remove it. Use only a dead blow mallet and tap only on tab at top of impeller cover plate. **DO NOT PRY COVER OFF.**

Secure impeller shaft at rear of supercharger housing using a shaft holding tool. Loosen, but do not remove the clutch side (engine side) nut. (Figure 5)

Figure 5



Continue to hold the impeller shaft in place using the shaft holding tool. Remove impeller shaft nut (1) and washer. **NOTE: You must turn nut clock-wise as threads are left-handed.** (Figure 6)

Figure 6

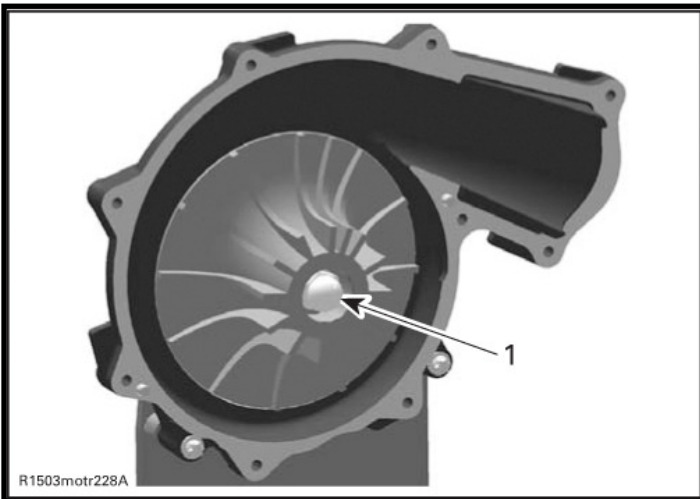

Carefully remove OEM impeller by twisting and pulling. **NOTE:** Make sure o-ring (1) is in place against step collar on impeller shaft. Inspect back of impeller if o-ring (1) is not on impeller shaft. (Figure 7)

Figure 7

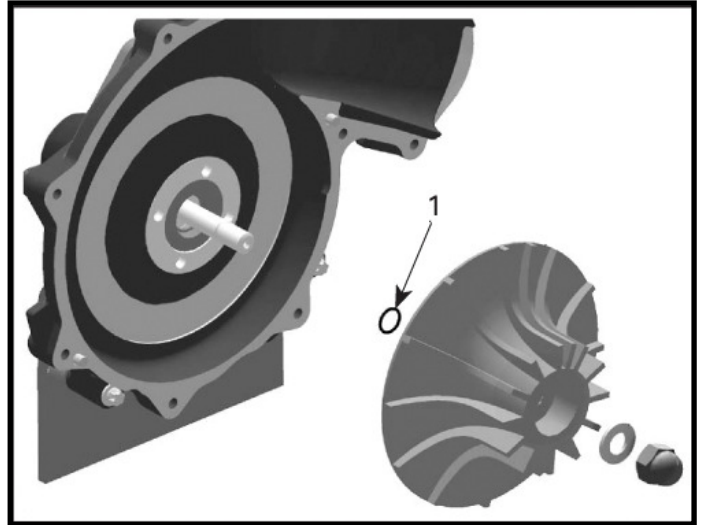

Thoroughly clean supercharger housing and impeller shaft with a non-residual cleaner. Remove all silicone from edge of supercharger housing (1) (Figure 8)

Figure 8

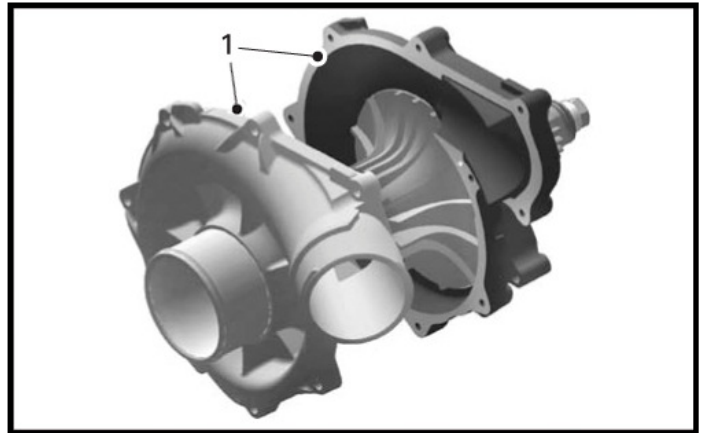

Inspect and clean supplied RIVA Impeller thoroughly taking care not to damage fins.

Warm impeller using a heat gun or hair dryer. **NOTE: Do not use a torch**

Install RIVA impeller onto impeller shaft completely.

Install OEM flat washer and impeller nut. **NOTE: You must turn nut counter clock-wise as threads are left-handed. Apply Blue Loc-tite to threads inside of impeller nut.**

Secure impeller shaft at rear of supercharger unit using shaft holding tool. Tighten impeller nut (counter clock-wise). **NOTE: Torque nut to 25 ft•lbs / 34 N•m**

Continue to hold the impeller shaft in place using the shaft holding tool. Tighten the clutch side (engine side) nut. **NOTE: Torque nut to 22 ft•lbs / 30 N•m.**

- INSTALLATION INSTRUCTIONS -

Apply a thin coat of Loc-Tite Sealant 5910 to both sides of supplied spacer plate (1).

Spread evenly covering surface completely. Clean any excess sealant at inner edge of spacer so as to prevent sealant from discharging into impeller area when halves are joined together. (Figure 9)

Figure 9

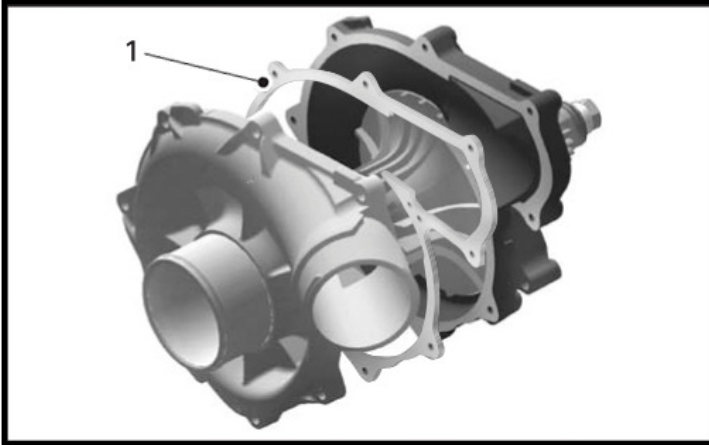

Reinstall supercharger impeller cover and secure with the nine OEM M6 x 35mm Torx screws. **NOTE: Apply blue Loc-tite to bolts. Torque bolts in sequence to 97lbf•in / 11 N•m. (Figure 10)**

Figure 10

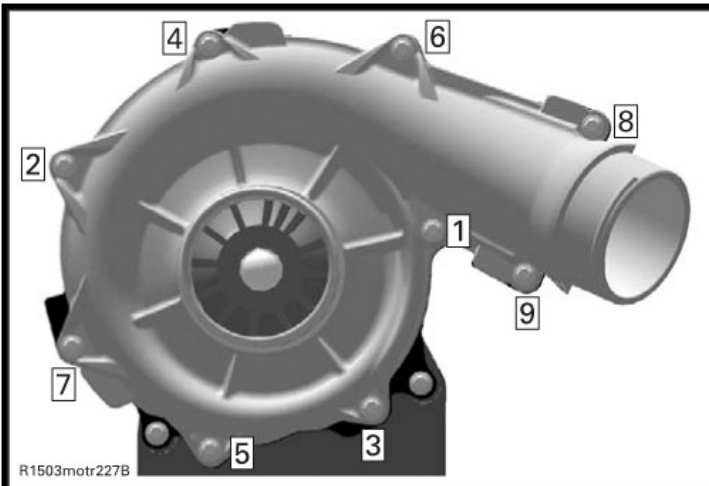

Spin impeller shaft to ensure smooth operation.

Remove supercharger unit from service mounting plate. Inspect o-rings at rear of impeller housing where it installs into engine. If either is damaged replace both.

Thoroughly coat unpainted area on rear of supercharger unit with grease.

Note: Make sure not to cover the oil port (1) with grease.(Figure 11)

Figure 11

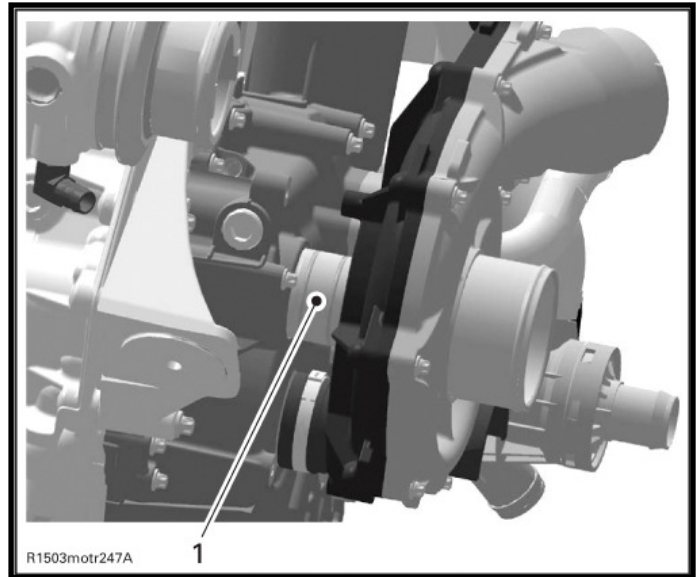

Install supercharger unit onto engine. **NOTE: You may need to rotate supercharger impeller to allow super-charger gear to mesh with flywheel gear.**

Secure supercharger unit to engine using the three M6 x 35mm Torx bolts removed in step 5. **NOTE: Apply blue Loc-tite to bolts. Torque bolts to 97lbf•in / 11 N•m**

Replace water box connections. **NOTE: Do not over tighten clamps.**

Replace supercharger inlet and outlet hoses and secure. **NOTE: Do not over tighten clamps.**

RXP-X 260 Models: Reinstall rear grab handle and coolant reservoir.

Re-connect battery cables. **NOTE: Positive (red) first. Negative (black) second.**

Check bilge for tools, rags, etc. Run craft on a flush kit to check for proper operation.

IMPORTANT: Break in period for this supercharger is 1-2 hours. Check and/or adjust the slip on the SC shaft after 2 hours of operation after installation. The slip moment setting for the RIVA 001C should be 14-15 foot lbs. For optimum performance, inspect/adjust the slip again in 10-20 hours (depending upon application & water conditions). Once you have noticed the slip has stabilized, you may go longer between slip inspections.

Note: Installation of this kit into Sea-Doo 215 models requires that the OEM fuel injectors be replaced with 42lb. fuel injectors such as RIVA part number 0280155968.

Failure to do so will result in serious engine damage.

***Remember, the water belongs to everyone.
Please ride responsibly and respect the environment!***

Technical Support

For answers to questions regarding installation or trouble shooting RIVA Performance Products contact:

RIVA Technical Support directly at (954) 247-0705 or by e-mail at tech_support@rivamotorsports.com.

Limited Warranty

RIVA Supercharger Kits carry a 90 day limited warranty to the original purchaser. They are warranted to be free of defects in materials and workmanship under normal use and service. Customer modified components will be void of warranty. This warranty is limited to defects in the primary components only. Finish and/or wear marks in or on primary components are not covered under this warranty.

RIVA Racing's liability is expressly limited to the repair or replacement of the components contained within or associated with this kit. RIVA Racing agrees to repair or at RIVA's option, replace any defective unit without charge, if product is returned to RIVA Racing freight prepaid within the warranty period. Any equipment returned which, in RIVA's opinion, has been subjected to misuse, abuse, overheating or accident shall not be covered by this warranty.

RIVA Racing shall have no liability for special, incidental or consequential damages or injury to persons or property from any cause arising from the sale, installation or use of this product.

No other warranty, express or implied, including, but not limited to the implied warranties of merchantability and fitness for a particular purpose, applies. Various states do not allow for the limitation of incidental or consequential damages and therefore the above exclusion or limitation may not apply to you.

Warranty does not include the expenses related to freight or transportation of parts or compensation for any inconvenience or loss of use while being repaired. A copy of the original invoice and a Return Authorization Number (RA#) must accompany all warranty claims.

Warranted replacement parts will be returned freight collect.

This area intentionally left blank