



RIVA RACING
PERFORMANCE PRODUCTS & ACCESSORIES

Free Flow Exhaust Kit

PART# - RY16070



APPLICATION(S): 2012+ Yamaha FX Models

We strongly recommend the use of a service manual to familiarize yourself with the various components and procedures involved with this installation. Please note that some of the original clamps, hoses and hardware removed in the disassembly process will be used in the installation process. These instructions have been written in step-by-step format and refer to illustrations. Read through instructions entirely before performing installation. Please follow these step-by-step instructions and illustrations carefully.

***** ALLOW ENGINE TO COOL COMPLETELY BEFORE PERFORMING INSTALLATION *****

- INSTALLATION INSTRUCTIONS -

Allow engine to cool completely.

Remove seats and rear storage bin. Remove seat support (five bolts).



2012-2018 models: Inside engine compartment at rear of craft remove and discard small exhaust baffle from exhaust hose.

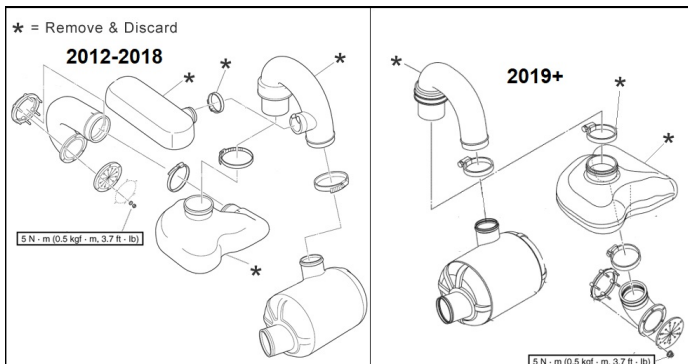

Loosen hose clamp securing OE exhaust hose to the water box (muffler). Disconnect hose from water box.

2012-2018 Rotate section of hose forward to allow access to clamp behind sound baffle. Loosen clamp and remove sound baffle with exhaust hose. Save clamps for installation portion.

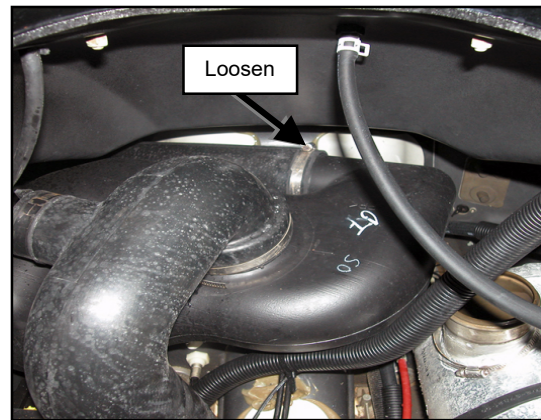

2019+ Loosen clamp under left rear of resonator and remove resonator with exhaust hose.

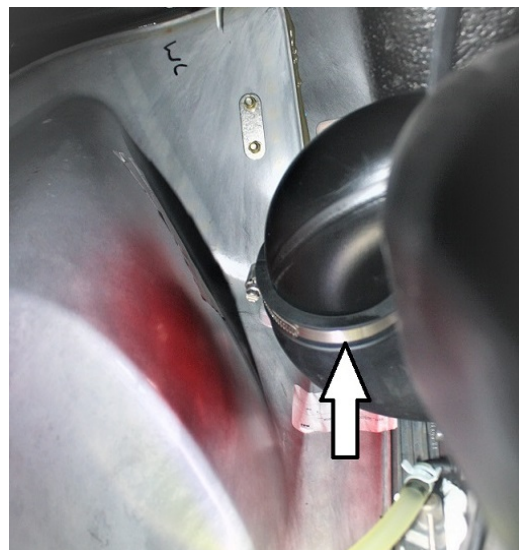

In jet pump area locate and remove rubber flap to right of jet pump unit.

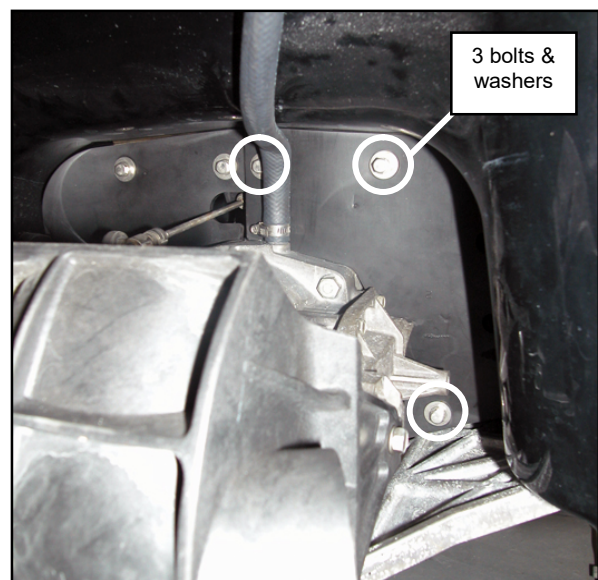

At exhaust outlet remove the six nuts and washers securing exhaust outlet to hull. **Note position exhaust outlet hose is facing prior to removing.**

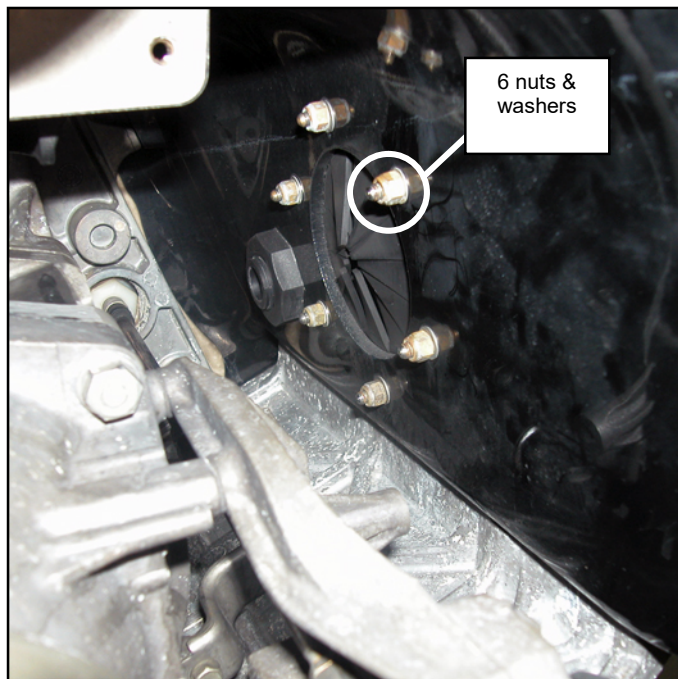

Remove exhaust outlet hose.

2012-2018 models only, cut at location shown below. **TIP: Use clamp as a guide.**

Do not cut hose on 2019+ models.



Thoroughly clean inside of OE exhaust outlet hose and outside of water box outlet with a non-residual cleaner.

Reinstall OEM exhaust outlet rotated forward one bolt hole, as shown. Secure using OE nuts and washers. **NOTE: Do not over tighten nuts.**



NOTE: Do not use any sealant when replacing exhaust outlet. Only nuts and washers should be on outside of hull after replacing exhaust outlet.

Replace rubber flap to right of jet pump unit.

Install supplied silicone coupler halfway onto water box outlet and secure using supplied hose clamp. **NOTE: Do not over tighten clamp.**



Loosely place one OE clamp over modified exhaust outlet hose and water box coupler.

Insert straight end of Free Flow Exhaust Tube into modified exhaust outlet hose. **TIP:** Use window cleaner to ease installation. Roll into outlet from bottom to top.



Insert curved end of Free Flow Exhaust Tube into coupler on water box outlet. **TIP:** Use window cleaner to ease installation. **NOTE:** It may be necessary to rotate water box to align Free Flow Tube with exhaust outlet coupler. To do so loosen hose clamp securing exhaust coupler to water box.

Tighten remaining hose clamps (2) securing Free Flow Exhaust tube in place. **NOTE: Do not over tighten clamps.**

Replace seat support (five bolts). **NOTE: Do not over tighten.**

Check bilge for tools, rags, etc. Run craft on a flush kit to check for proper operation.

Remember, the water belongs to everyone.

Please ride responsibly and respect the environment!

Technical Support

For answers to questions regarding installation or trouble shooting RIVA Performance Products contact:

RIVA Technical Support directly at (954) 247-0705 or by e-mail at tech_support@rivamotorsports.com.

Limited Warranty

RIVA Free Flow Exhaust Kits carry a 1-year limited warranty to the original purchaser. They are warranted to be free of defects in materials and workmanship under normal use and service. Customer modified components will be void of warranty. This warranty is limited to defects in the primary components only. Finish and/or wear marks in or on primary components are not covered under this warranty.

RIVA Racing's liability is expressly limited to the repair or replacement of the components contained within or associated with this kit. RIVA Racing agrees to repair or at RIVA's option, replace any defective unit without charge, if product is returned to RIVA Racing freight prepaid within the warranty period. Any equipment returned which, in RIVA's opinion, has been subjected to misuse, abuse, overheating or accident shall not be covered by this warranty.

RIVA Racing shall have no liability for special, incidental or consequential damages or injury to persons or property from any cause arising from the sale, installation or use of this product.

No other warranty, express or implied, including, but not limited to the implied warranties of merchantability and fitness for a particular purpose, applies. Various states do not allow for the limitation of incidental or consequential damages and therefore the above exclusion or limitation may not apply to you.

Warranty does not include the expenses related to freight or transportation of parts or compensation for any inconvenience or loss of use while being repaired. A copy of the original invoice and a Return Authorization Number (RA#) must accompany all warranty claims.

Warranted replacement parts will be returned freight collect.