



## Free Flow Exhaust Kit

**PART# - RY16040**

**APPLICATIONS:** 2011~08 Yamaha FX-SHO/FZ, 2009 FX-HO

## **- INSTALLATION INSTRUCTIONS -**

1. Allow engine to cool completely.
2. Remove seats and rear storage bin. **FZ Models Only:** Remove rear grab handle/seat support. Four bolts at center and three under grab handle.
3. Inside engine compartment at rear of craft remove small exhaust baffle from exhaust hose. (see illustration #1) Save OE clamp for installation portion.
4. Loosen hose clamp securing OE exhaust hose to the water box (muffler). Disconnect hose from water box.
5. Rotate section of hose forward to allow access to clamp behind sound baffle. Loosen clamp and remove sound baffle with exhaust hose. (see illustration #2) Save OE clamps for installation portion.
6. In jet pump area locate and remove rubber flap to right of jet pump unit. (see illustration #3) At exhaust outlet remove the six nuts and washers securing exhaust outlet to hull. (see illustration #4)
7. Note position exhaust outlet hose is facing. Remove exhaust outlet hose and cut at location marked in illustration #5. **TIP:** Use clamp as a guide.
8. Thoroughly clean inside of OE exhaust outlet hose and outside of water box outlet with a non-residual cleaner.
9. Replace modified stock exhaust outlet. Before doing so rotate forward one bolt hole. (see illustration #6) Secure using OE nuts and washers. Torque to 5.4 N•m (0.54 kgf • m, 3.9 fl • lb) **NOTE: Do not use any sealant when replacing modified exhaust outlet. Nuts and washers only should be on outside of hull after replacing modified exhaust outlet.**
10. Replace rubber flap to right of jet pump unit.
11. Install supplied silicone coupler halfway onto water box outlet and secure using supplied hose clamp. (see illustration #7) **NOTE: Do not over tighten clamp.**
12. Loosely place one OE clamp over modified exhaust outlet hose and water box coupler.
13. Insert straight end of Free Flow Exhaust Tube into modified exhaust outlet hose. Use window cleaner to ease installation.
14. Insert curved end of Free Flow Exhaust Tube into coupler on water box outlet. Use window cleaner to ease installation. **NOTE:** It may be necessary to rotate water box to align Free Flow Tube with exhaust outlet coupler. To do so loosen hose clamp securing exhaust coupler to water box. (see illustration #1)
15. Tighten remaining hose clamps (2) securing Free Flow Exhaust tube in place. (see illustration #8) **NOTE: Do not over tighten clamps.**
16. **FZ Models Only:** Replace rear grab handle/seat support. Four bolts at center and three under grab handle.
17. Check bilge for tools, rags, etc. Start craft and run using flush kit to check for exhaust leaks at connecting points of Free Flow Exhaust Kit.

## Technical Support

For answers to questions regarding installation or trouble shooting RIVA Performance Products contact:  
RIVA Technical Support directly at (954) 247-0705 or by e-mail at [tech\\_support@rivamotorsports.com](mailto:tech_support@rivamotorsports.com)

### Warranty

RIVA Racing Free Flow Exhaust Kits carry a one-year limited warranty to the original purchaser. They are warranted to be free of defects in materials and workmanship under normal use and service. Customer modified components will be void of warranty. This warranty is limited to defects in the primary components only. Finish and/or wear marks in or on primary components are not covered under this warranty.

RIVA Racing's liability is expressly limited to the repair or replacement of the components contained within or associated with this kit. RIVA Racing agrees to repair or at RIVA's option, replace any defective unit without charge, if product is returned to RIVA Racing freight prepaid within the warranty period. Any equipment returned which, in RIVA's opinion, has been subjected to misuse, abuse, overheating or accident shall not be covered by this warranty.

RIVA Racing shall have no liability for special, incidental or consequential damages or injury to persons or property from any cause arising from the sale, installation or use of this product.

No other warranty, express or implied, including, but not limited to the implied warranties of merchantability and fitness for a particular purpose, applies. Various states do not allow for the limitation of incidental or consequential damages and therefore the above exclusion or limitation may not apply to you.

Warranty does not include the expenses related to freight or transportation of parts or compensation for any inconvenience or loss of use while being repaired. A copy of the original invoice must accompany all warranty claims.

Warranted replacement parts will be returned freight collect.

## - INSTALLATION IMAGES -

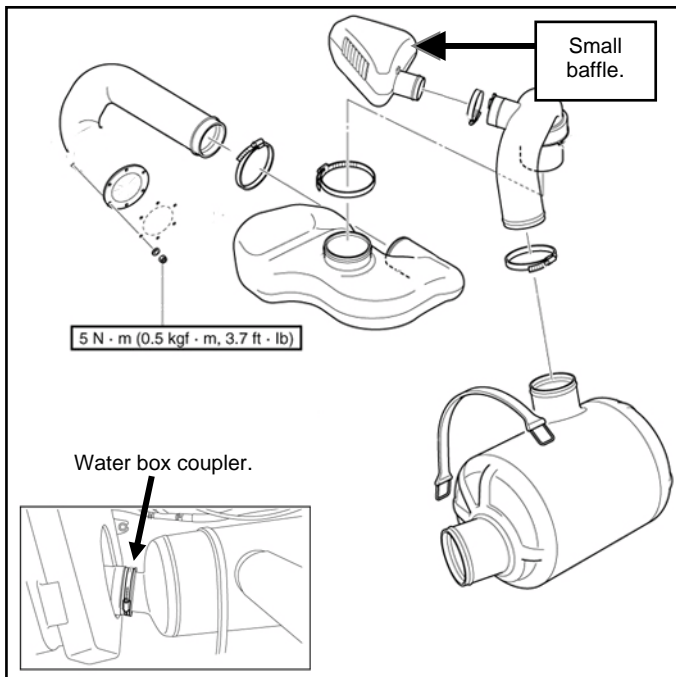

Illustration #1



Illustration #2

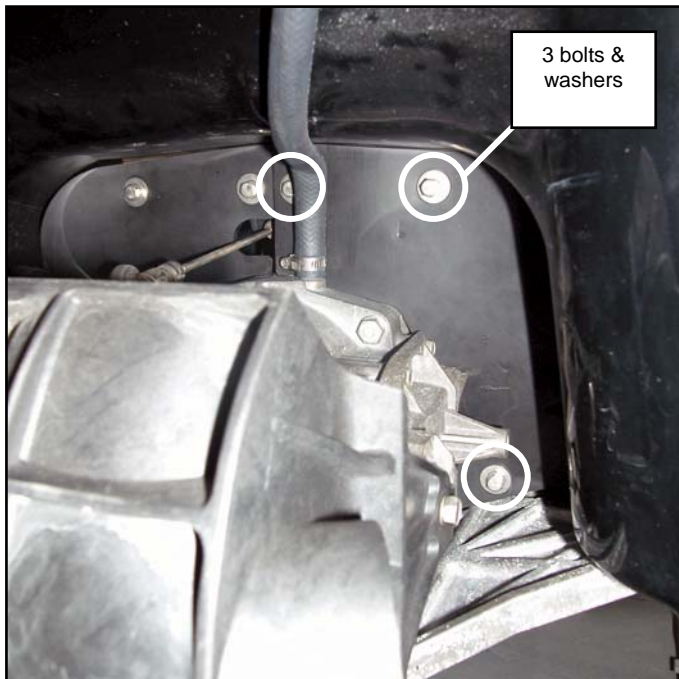

Illustration #3



Illustration #4



Illustration #5

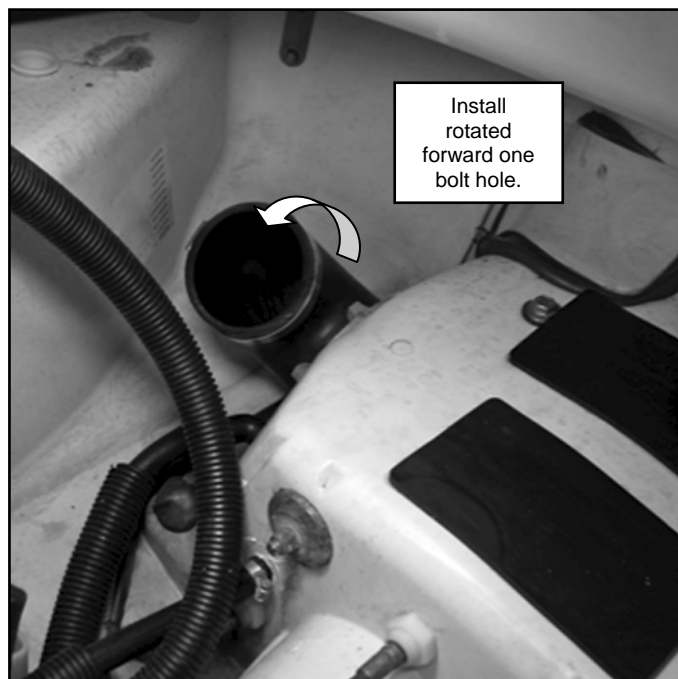

Illustration #6



Illustration #7

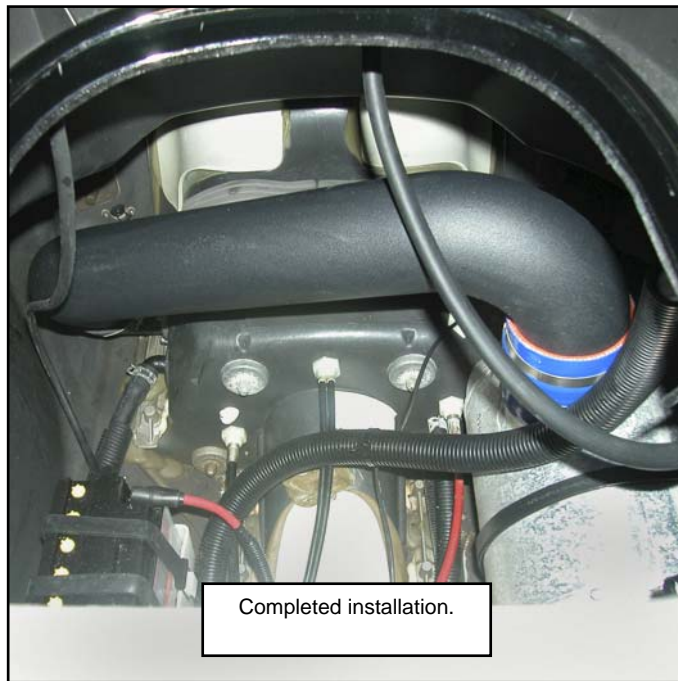

Illustration #8