



RIVA RACING
PERFORMANCE PRODUCTS & ACCESSORIES

"Last Drop" Oil Extraction System

PART# - RY10040-OES



APPLICATION(S): 2012 & Newer 1.8L engine models (SVHO / SHO / HO). FZR models starting with engine 6AN1013200. VXR/VXS models starting with engine #6CN1005800.

We strongly recommend the use of a Yamaha service manual to familiarize yourself with the various components and procedures involved with this installation. Please note that some of the original clamps, hoses and hardware removed in the disassembly process will be used in the installation process. These instructions have been written in step-by-step format and refer to illustrations. Read through instructions entirely before performing installation. Please follow these step-by-step instructions and illustrations carefully.

Required Specialty Tools

Fluid Extraction Pump

Part#

18-2720, for 6 liter / OIL03, for 15 liter

- INSTALLATION INSTRUCTIONS -

Place watercraft in a level and horizontal position.

Start & run the engine on the flush hose for 5 minutes at idle speed.

Turn off water hose, then shut off the engine.

Disconnect safety lanyard. Disconnect negative battery cable.

Remove the 2 screws on top of the engine cover. Pull straight up on engine cover & remove.



Remove oil level dip stick & oil filler cap on cylinder head.

Extract all the engine oil through the oil dip stick tube using a fluid extractor.

Note: RIVA Racing suggests replacing the oil filter at this time.

Allow engine to cool thoroughly before performing installation.

Remove the 12mm head oil pan drain plug. This is located under the engine, at the rear of the engine.

Note: place a rag under the oil pan to catch any possible residual oil.

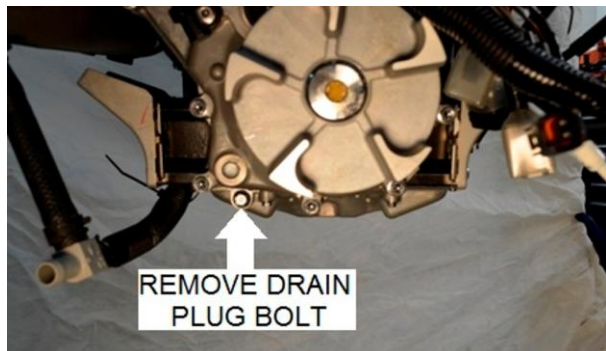

Note the location of the ratchet extension is almost directly under the coupler cover dampener. (See illustration below)



Slide the supplied crush washer over the threaded end of the black hex adaptor & install in the oil pan where the drain plug was. **Tip:** Place a very small amount of grease between the hex adaptor & the crush washer. This will hold the crush washer in place while installing the black hex adaptor.

Using a 13mm socket, tighten the black hex adaptor piece to 5 foot pounds. (60 inch pounds) **DO NOT OVERTIGHTEN THE HEX ADAPTOR!** Over tightening the hex piece may result in the threads breaking off in the oil pan.

Remove the two 10mm head bolts on the generator cover shown in the illustration.

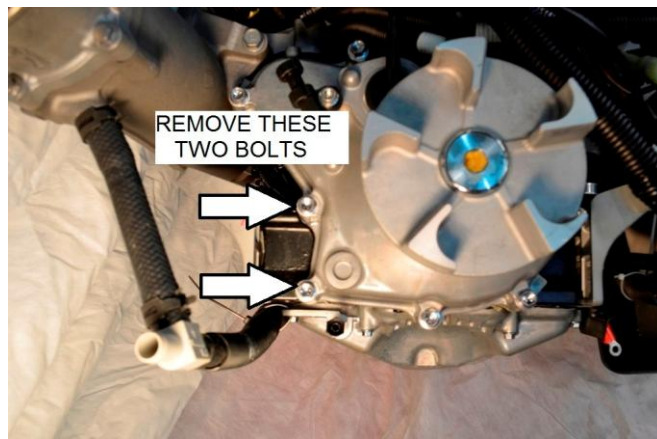

Install the supplied support bracket by sliding the grommet over the hex adaptor piece. Use window cleaner on the grommet so it slides into place easily.

Align the bracket with the two bolt holes on the generator cover & reinstall the two 10mm head bolts. Tighten bolts to 19.2 foot pounds.



Remove the 14mm head exhaust pipe mounting bolt.

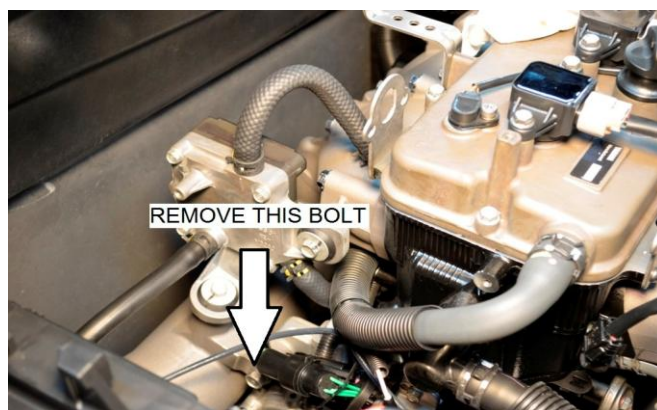

Place the oil extraction tube in position by fastening the upper mounting bracket in place using the 14mm head exhaust pipe mounting bolt. Do not tighten, keep very loose.

Carefully thread in by hand the brass flare nut into the black hex adaptor piece.

Using a 13mm open end wrench, hold the black hex adaptor piece in position while tightening the brass flare nut with a 7/16" open wrench. **Note:** You DO NOT want to further tighten the black hex adaptor piece.

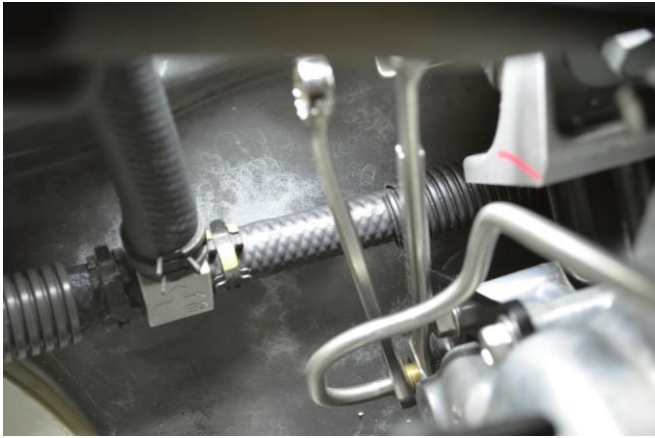

Tighten the 14mm head exhaust mounting bolt holding the upper oil tube bracket in place. Torque bolt to 31 foot pounds.

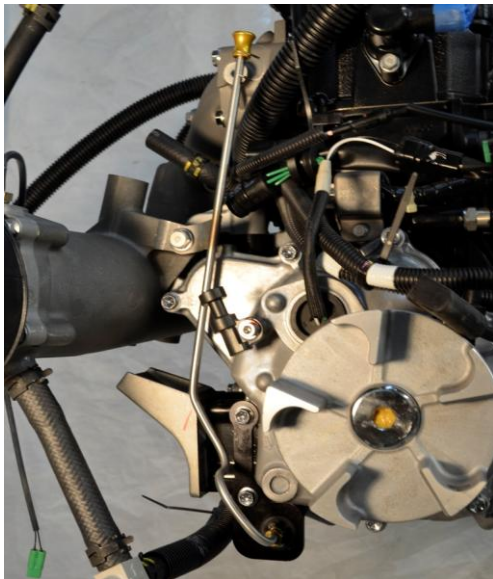

Refill the engine oil through the oil filler hole on the cylinder head to the correct level and reinstall the oil filler cap.

Reinstall the oil level dip stick & confirm the oil level is correct.

Reinstall the engine cover.

Reconnect negative cable on battery.

Installation is now complete. Thoroughly inspect engine compartment and bilge for tools, rags, parts, etc. Run craft on stand using flush kit to check for proper operation.

You are now ready to use your "Last Drop" Oil Extraction System. In order to extract oil from the engine, remove the cap on top of the oil extraction tube. Attach the supplied adaptor hose to the top of the oil extraction tube. Attach the hose from your fluid extractor to the adaptor hose. After extracting the engine oil, remove the adaptor hose & reinstall cap on top of oil extraction tube.

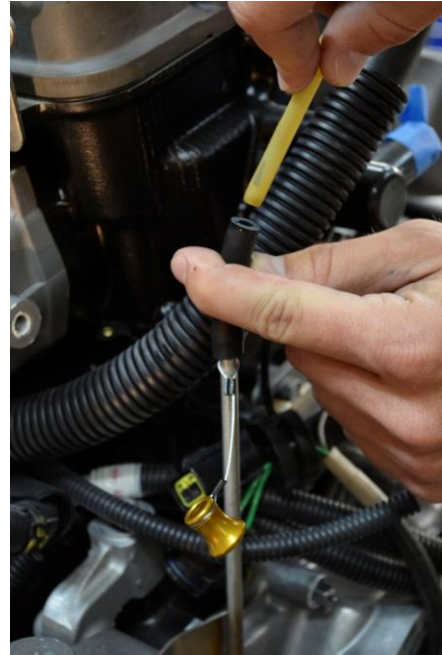

***Remember, the water belongs to everyone.
Please ride responsibly and respect the environment!***

Technical Support

For answers to questions regarding installation or trouble shooting RIVA Performance Products contact:
RIVA Technical Support directly at (954) 247-0705 or by e-mail at tech_support@rivamotorsports.com.

Limited Warranty

RIVA Racing parts carry a 6 month limited warranty to the original purchaser. They are warranted to be free of defects in materials and workmanship under normal use and service. Customer modified components will be void of warranty. This warranty is limited to defects in the primary components only. Finish and/or wear marks in or on primary components are not covered under this warranty.

RIVA Racing's liability is expressly limited to the repair or replacement of the components contained within or associated with this kit. RIVA Racing agrees to repair or at RIVA's option, replace any defective unit without charge, if product is returned to RIVA Racing freight prepaid within the warranty period. Any equipment returned which, in RIVA's opinion, has been subjected to misuse, abuse, overheating or accident shall not be covered by this warranty.

RIVA Racing shall have no liability for special, incidental or consequential damages or injury to persons or property from any cause arising from the sale, installation or use of this product.

No other warranty, express or implied, including, but not limited to the implied warranties of merchantability and fitness for a particular purpose, applies. Various states do not allow for the limitation of incidental or consequential damages and therefore the above exclusion or limitation may not apply to you.

Warranty does not include the expenses related to freight or transportation of parts or compensation for any inconvenience or loss of use while being repaired. A copy of the original invoice and a Return Authorization Number (RA#) must accompany all warranty claims.

Warranted replacement parts will be returned freight collect.